

I:ME

Innovative Manufacturing Engineering

32711 Glendale Ave. Livonia MI 48150-1611 734-466-8750 imedetroit.com

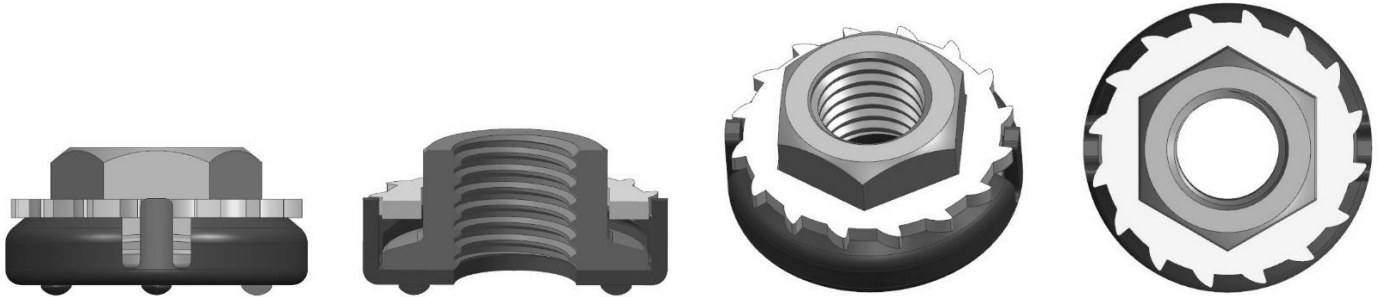

- **AN EXTREME DUTY LOCKING SYSTEM WITH INTEGRATED FASTENER**
- **LOCK PAWL WILL ENGAGE THE RATCHET TOOTH AND CAN NOT BACK OFF**
- **SECURELY ATTACH A GEAR OR PULLEY TO KEYED SHAFTS**
- **SUCCESSFULLY ENGAGES TO ALUMINUM, PLASTIC OR METAL SURFACES**
- **PRECISELY DIAL IN YOUR TARGETED JOINT CLAMP LOAD A CLICK AT A TIME**
- **CAN PREVENT UNAUTHORIZED TAMPERING WITH SECURE CONNECTIONS**
- **REMOVABLE AND REUSABLE FASTENING SYSTEM FOR FIELD REPAIRS**
- **SUPERIOR RESISTANCE TO VIBRATION LOOSENING IN SEVERE ENVIRONMENTS**
- **EFFECTIVE RESISTANCE TO EXTREME THERMAL CYCLING EFFECTS**



VOSB

ITAR Compliant

NIST SP800-171 Compliant

Cage Code : 7GQY1