

I:ME

Innovative Manufacturing Engineering

32711 Glendale Ave. Livonia MI 48150-1611 734-466-8750 imedetroit.com

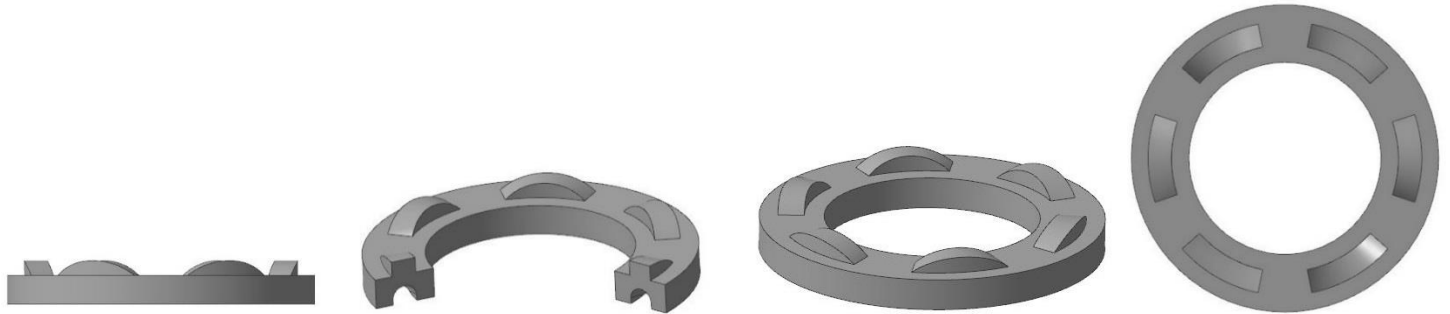

- A PRECISE **MECHANICAL LOAD CELL** FOR CLAMP LOAD ASSURANCE
- HIGHLY **ACCURATE JOINT TENSION** REGARDLESS OF FASTENER LUBRICITY
- CAN CREATE **CUSTOM LOAD INDICATORS** FOR SPECIALTY APPLICATIONS
- CLAMP LOAD ASSURANCE THAT IS **NOT INFLUENCED BY FRICTION**
- SUPERIOR **RESISTANCE TO VIBRATION LOOSENING** IN SEVERE ENVIRONMENTS
- EFFECTIVE **RESISTANCE TO EXTREME THERMAL CYCLING** EFFECTS
- **SIMPLIFIED ASSEMBLY** CALIBRATED TORQUE WRENCH IS NOT REQUIRED
- **PROVEN TO REDUCE ASSEMBLY TIME** AND ELIMINATE ASSEMBLY ERRORS

Method 1

DTI under head - Turn nut to tighten, bolt head held.

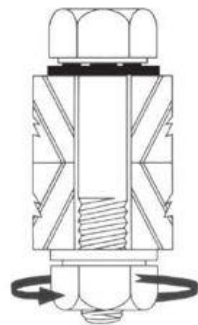

Method 2

DTI under the nut - Turn the nut to tension.



Method 3

DTI under the bolt head - Turn the bolt head to tension.



The logo for Innovative Manufacturing Engineering (IME) features the letters 'I', 'M', and 'E' in a large, bold, sans-serif font. The 'I' is red, and the 'M' and 'E' are blue. The background of the logo is a dark blue and black 3D grid pattern.

Innovative Manufacturing Engineering

32711 Glendale Ave. Livonia MI 48150-1611 734-466-8750 imedetroit.com

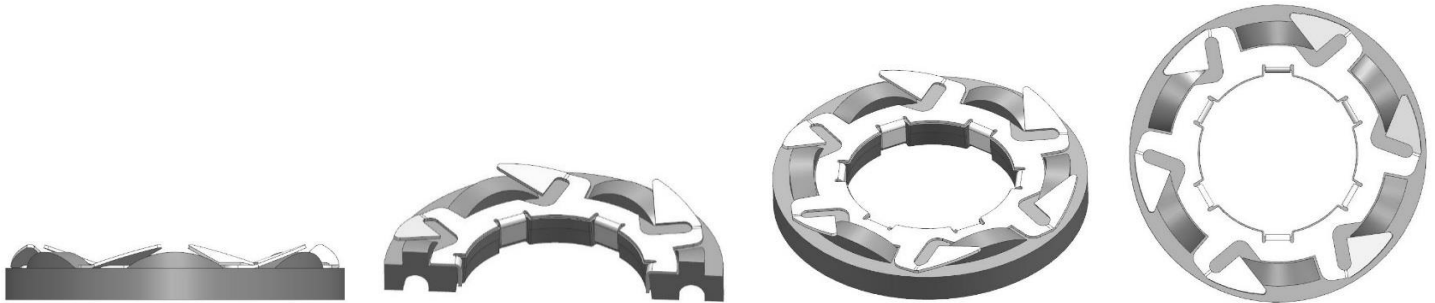

- A PRECISE **MECHANICAL LOAD CELL** FOR CLAMP LOAD ASSURANCE
- **FINS DEPLOY** AT SPECIFIED TENSION **VERIFY BY VISUAL OR TOUCH**
- **HIGHLY ACCURATE JOINT TENSION** REGARDLESS OF FASTENER LUBRICITY
- CLAMP LOAD ASSURANCE THAT IS **NOT INFLUENCED BY FRICTION**
- **SUPERIOR RESISTANCE TO VIBRATION LOOSENING** IN SEVERE ENVIRONMENTS
- **EFFECTIVE RESISTANCE TO EXTREME THERMAL CYCLING EFFECTS**
- **SIMPLIFIED ASSEMBLY CALIBRATED TORQUE WRENCH IS NOT REQUIRED**
- **PROVEN TO REDUCE ASSEMBLY TIME AND ELIMINATE ASSEMBLY ERRORS**



VOSB

ITAR Compliant

NIST SP800-171 Compliant

Cage Code : 7GQY1